

Residential Services Guide

Compost Your Holiday Tree



Set clean trees at the curb for collection on your regular compost collection day until January 12, 2024. After January 12, cut trees to fit in your compost cart for regular weekly collection.



NO STANDS



NO ORNAMENTS



NO FLOCKING

Flocked trees cannot be composted; cut flocked trees down and dispose in your trash cart or use bulky drop off service.

Break Down Your Holiday Packages

Break down boxes to avoid overfilling your recycle cart.

- Broken down cardboard boxes should be no larger than 3ft x 3ft.
- Place in or next to your recycle cart.
- Make sure cardboard is free of plastic film and foam packaging. Plastic film and foam belong in your trash cart.



Visit OaklandRecycles.com/single-family-homes for more information about other services.



Recycle Your Used Household Batteries

Put used batteries in a clear zip-lock bag, then place the sealed bag on top of your recycle cart/bin on your regular pickup day.



Include only household dry-cell batteries such as: alkaline, button cell, or ni-cadmium.

HAZARD WARNING

Disposing of the batteries in your cart can cause fires in the recycle truck or sorting facility.

Consumer batteries can short-circuit if their ends come in contact with one another. Place button-cell and ni-cadmium batteries in separate, clear zip-lock plastic bags and tape ends of batteries to avoid contact.

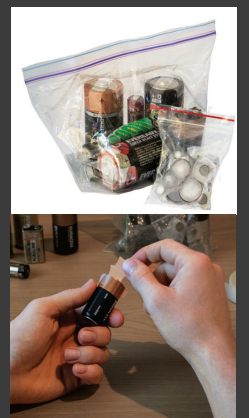

Got Unwanted Appliances or Electronics?

These items do not belong in your trash, recycle, or compost cart. Choose from the options below to prevent environmental and fire hazards that result when electronics are disposed of incorrectly.



Reuse

Many common household appliances can be reused, repaired or recycled. Search RE:Source, StopWaste's on-line guide to reuse, repair, and recycling just about anything. It contains information on reuse organizations and drop-off locations. Many of the locations also sell used items. Visit resource.stopwaste.org.



Curbside Pickup Service

Bulky junk curbside services are available to owners and renters and included for no additional cost with your trash service. You can set out consumer electronics and up to two large appliances. In addition you can set out up to 4 cubic yards of bulky waste and a limited number of other items for bulky curbside pickup.

Schedule a bulky curbside pickup by calling 1-888-WM-BULKY (1-888-962-8559) or visit OaklandRecycles.com/Bulky for more information and online scheduling.



Drop Off Services

Schedule your appointment to bring up to 4 cubic yards of bulky waste, including appliances and consumer electronics to the Davis Street Resource Recovery Complex in San Leandro. This service is included for no additional cost with your trash service.

Schedule a bulky drop off appointment by calling 1-888-WM-BULKY (1-888-962-8559) or visit OaklandRecycles.com/Bulky for more information and online scheduling.

You can also drop off used appliances and electronics at anytime to the Davis Street Resource Recovery Complex in San Leandro for a fee. For a list of acceptable materials and disposal rates visit DavisStreet.wm.com.

Household Hazardous Waste Facility

Take consumer electronics, small appliances and other hazardous materials like paint, chemicals and solvents to the Household Hazardous Waste Facility at 2100 East 7th Street, Oakland. Drop offs are limited to 15 gallons/125 pounds per vehicle. Call (800) 606-6606 or visit www.stopwaste.org/at-home/household-hazardous-waste for days and hours of operation.

